



# Positive Controls for Panbio™ COVID-19/Flu A&B Rapid Panel

- Ensure performance of the Panbio™ COVID-19/Flu A&B Rapid Panel
- Verify the user's ability to properly perform the test and interpret the results
- The Positive Control will produce positive test results and will produce visible test lines ("FLU B", "FLU A", "COV 19") and control line "C"
- Results in 15 minutes



# INTENDED USE

Positive Controls are quality control swabs for use with Panbio™ COVID-19/Flu A&B Rapid Panel only.

It is the responsibility of each laboratory using Panbio™ COVID-19/Flu A&B Rapid Panel to establish an adequate quality assurance program to ensure the performance of the device under its specific conditions of use.

Perform the Positive Controls for Panbio™ COVID-19/Flu A&B Rapid Panel at periodic intervals as indicated by user facility, such as:

- When training a new operator prior to them performing tests on patient specimens
- When opening a new test lot
- Whenever a new shipment of test kits is received

# SPECIFICATIONS/USAGE

- **TEST TIME:** 15 minutes
- **STORAGE:** 2°C–30°C
- **SAMPLE TYPE:** Positive control swab contains three recombinant antigens of each pathogen (SARS-CoV-2, Influenza A and B)
- **USAGE:** If cold-stored, the control kit must be brought to room temperature (15 - 30 °C) for a minimum of 30 minutes prior to performing the test

# TEST PROCEDURE

Consult Instructions for Use for complete procedure.

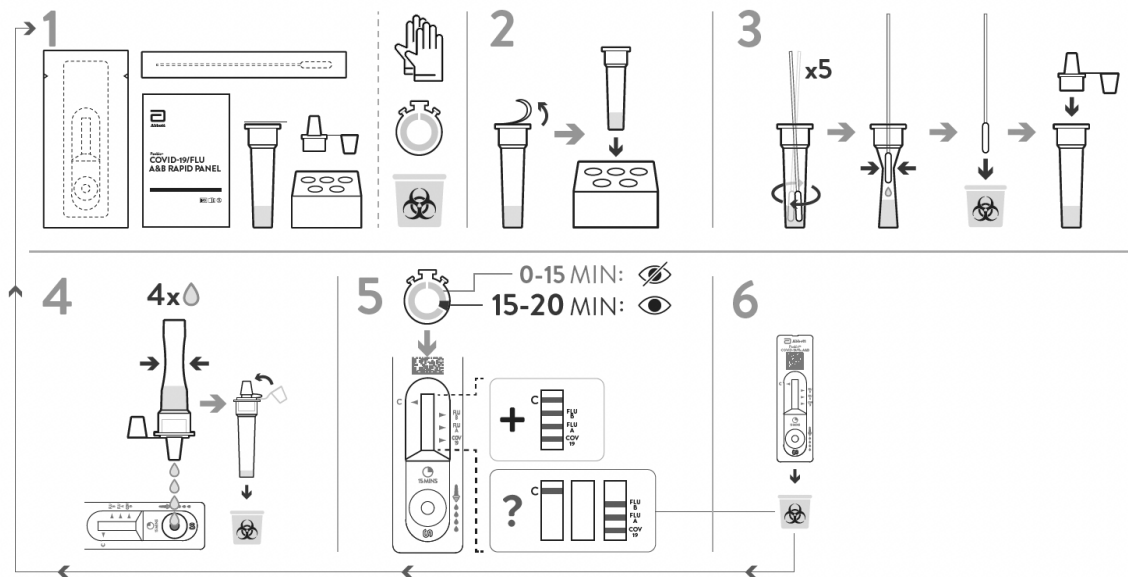

# ORDER INFORMATION

- **Positive Controls for Panbio™ COVID-19/Flu A&B Rapid Panel**
- **CATALOG NUMBER:** 62FK11C
- **CONTENTS:** 10 Positive Control Swabs, 1 Instructions for Use with Quick Reference Guide

# CONTACT YOUR LOCAL REPRESENTATIVE TODAY.

Product not available in all countries.

[globalpointofcare.abbott](http://globalpointofcare.abbott)